

KYCON Mini-DIN Connectors

RoHS Compliant This product is RoHS compliant.

RIGHT ANGLE PCB RECEPTABLES

- Fully Shielded for good conductivity, grounding, and EMI/RFI protection
- Mates with standard and snap and lock plugs
- Body Material: PBT Thermoplastic, UL94V-0 rated
- Contact Material: Phosphor Bronze, Gold plated
- RoHS Compliance per Kycon Documentation
- Shield Material: Brass, Tin Plated
- Solder Tails: Tin Plated Over Nickel
- Operating Temperature: -25°C to +85°C

MOUSER STOCK NO.	Kycon Part No.	Fig.	No. of Pos.	Color	Price Each			
					1	25	100	500
806-KMDGX-3S-BS	KMDGX-3S-BS	A	3	Black	.72	.64	.579	.529
806-KMDGX-4S-BS	KMDGX-4S-BS	A	4	Black	1.01	.98	.72	.58
806-KMDGX-4S-BS-99	KMDGX-4S-BS-99	A	4	† Pan 123C Yellow	1.04	1.00	.739	.599
806-KMDGX-5S-BS	KMDGX-5S-BS	A	5	Black	1.18	1.14	.83	.67
806-KMDGX-6S-BS	KMDGX-6S-BS	A	6	Black	1.25	1.22	.90	.66
806-KMDGX-6S-BS2715C	KMDGX-6S-BS2715C	A	6	† Pan 2715C Purple	1.12	1.09	.809	.639
806-KMDGX-6S-BS3395C	KMDGX-6S-BS3395C	A	6	† Pan 3395C Green	1.04	.99	.88	.70
806-KMDGX-7S-BS	KMDGX-7S-BS	A	7	Black	1.27	1.24	.919	.729
806-KMDGX-8S-BS	KMDGX-8S-BS	A	8	Black	1.24	1.21	.89	.70
806-KMDGX-9S-BS	KMDGX-9S-BS	A	9	Black	1.28	1.25	.92	.73
806-KMDGX-10S-BS	KMDGX-10S-BS	A	10	Black	2.01	1.96	1.43	1.15
With GEO S-Video Port								
806-KMDGX-GEO-7SBS	KMDGX-GEO-7S-BS	A	7	Black	.88	.78	.71	.64

RIGHT ANGLE FERRITE FILTERED PCB RECEPTABLES

- Fully Shielded for good conductivity, grounding, and EMI/RFI protection
- Mates with standard and snap and lock plugs
- Body Material: PBT Thermoplastic, UL94V-0 rated
- Contact Material: Phosphor Bronze, Gold plated
- RoHS Compliance per Kycon Documentation
- Shield Material: Brass, Tin Plated
- Solder Tails: Tin Plated Over Nickel
- Operating Temperature: -25°C to +85°C

MOUSER STOCK NO.	Kycon Part No.	Fig.	No. of Pos.	Color	Price Each			
					1	25	100	500
806-KFMDGX-4S-BS	KFMDGX-4S-BS	A	4	Black	1.47	1.30	1.16	1.05
806-KFMDGX-5S-BS	KFMDGX-5S-BS	A	5	Black	1.69	1.61	1.44	1.29
806-KFMDGX-6S-BS	KFMDGX-6S-BS	A	6	Black	2.77	2.52	2.30	1.85
806-KFMDGX-8S-BS	KFMDGX-8S-BS	A	8	Black	2.46	2.27	1.66	1.40

RIGHT ANGLE STACKED PCB RECEPTABLES

- Fully Shielded for good conductivity, grounding, and EMI/RFI protection
- Mates with standard and snap and lock plugs
- Body Material: PBT Thermoplastic, UL94V-0 rated
- Contact Material: Phosphor Bronze, Gold plated
- RoHS Compliance per Kycon Documentation
- Shield Material: Brass, Tin Plated
- Solder Tails: Tin Plated Over Nickel
- Operating Temperature: -25°C to +85°C

MOUSER STOCK NO.	Kycon Part No.	Fig.	No. of Pos.	Color	Price Each			
					1	25	100	500
806-KMDGX-4S/4S-S4N	KMDGX-4S/4S-S4N	B	4 over 4	Black	1.98	1.91	1.39	1.11
806-KMDGX-6S/6S-S4N	KMDGX-6S/6S-S4N	B	6 over 6	Black	1.93	1.88	1.38	1.10
806-KMDGX-6SG/P-S4N	KMDGX-6SG/P-S4N	B	6 over 6	† Pan 3395C Green over Pan 2715C Purple	2.56	2.50	1.67	1.21
806-KMDGX-6SGPS4N1	KMDGX-6SG/P-S4N1	B	6 over 6	Green/Purple	2.70	2.63	1.93	1.54
806-KMDGX-8S/8S-S4N	KMDGX-8S/8S-S4N	B	8 over 8	Black	3.30	2.41	1.72	1.54

RIGHT ANGLE ROUNDED LOW PROFILE PCB RECEPTABLES

- Contacts: Phosphor Bronze Gold Flash on contacts Tin on termination
- Body: PBT Thermoplastic, UL94V-0 rated
- Shield: SPCC, Tin plated
- Operating Temperature: -25°C to +85°C
- RoHS Compliance per Kycon Documentation



MOUSER STOCK NO.	Kycon Part No.	Fig.	No. of Pos.	Color	Price Each			
					1	25	100	500
806-KMDRX-4S-BS	KMDRX-4S-BS	C	4	Black	1.79	1.73	1.26	1.03
806-KMDRX-6S-BS	KMDRX-6S-BS	C	6	Black	1.89	1.82	1.33	1.07
Snap and Lock								
806-KMDRLX-4S-BS	KMDRLX-4S-BS	C	4	Black	1.70	1.55	1.38	1.28
806-KMDRLX-6S-BS	KMDRLX-6S-BS	C	6	Black	1.81	1.64	1.46	1.36

CABLE MOUNT PLUGS

- Insert Material: PBT Thermoplastic, UL94V-0 rated
- Shell Material: PVC, UL94V-0 rated
- Contact Material: Brass, Silver plated
- Shield Material: Nickel plated Iron sheet
- Durability: 1500 Cycles
- Operating Temperature: -25°C to +80°C
- RoHS Compliance per Kycon Documentation

MOUSER STOCK NO.	Kycon Part No.	Fig.	No. of Pos.	Color	Price Each			
					1	25	100	500
06-KMDAX-3P	KMDAX-3P	D	3	Black	1.09	.97	.87	.79
806-KMDAX-4P	KMDAX-4P	D	4	Black	1.39	1.23	1.10	.93
806-KMDAX-5P	KMDAX-5P	D	5	Black	1.36	1.20	1.08	.98
806-KMDAX-6P	KMDAX-6P	D	6	Black	1.88	1.74	1.27	1.08
806-KMDAX-7P	KMDAX-7P	D	7	Black	1.91	1.83	1.34	1.13
806-KMDAX-8P	KMDAX-8P	D	8	Black	2.01	1.92	1.40	1.19
806-KMDAX-9P	KMDAX-9P	D	9	Black	2.67	2.29	1.78	1.60
Snap and Lock								
806-KMDLAX-3P	KMDLAX-3P	E	3	Black	2.86	2.50	2.22	2.00
806-KMDLAX-4P	KMDLAX-4P	E	4	Black	3.02	2.64	2.34	2.11
806-KMDLAX-5P	KMDLAX-5P	E	5	Black	3.16	2.77	2.46	2.21
806-KMDLAX-6P	KMDLAX-6P	E	6	Black	2.81	2.46	2.19	1.97
806-KMDLAX-7P	KMDLAX-7P	E	7	Black	2.94	2.58	2.28	2.05
806-KMDLAX-8P	KMDLAX-8P	E	8	Black	3.07	2.69	2.39	2.15

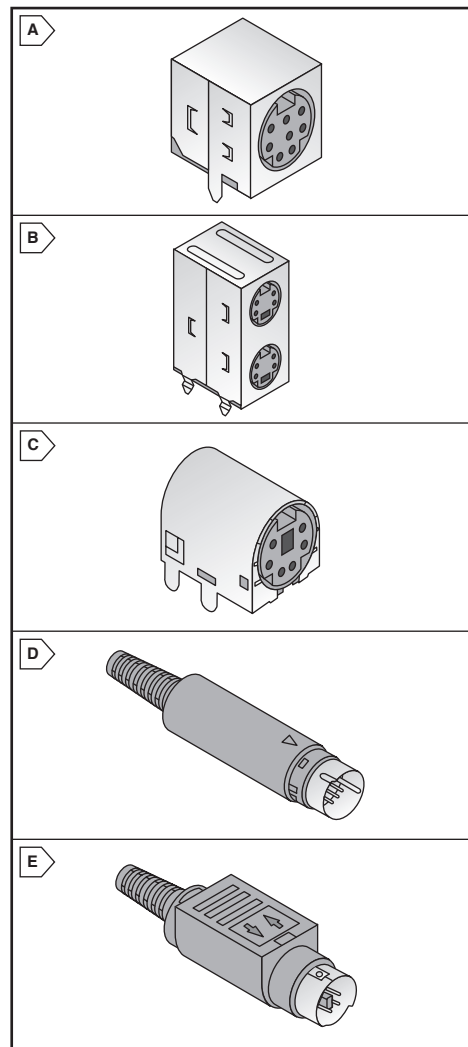
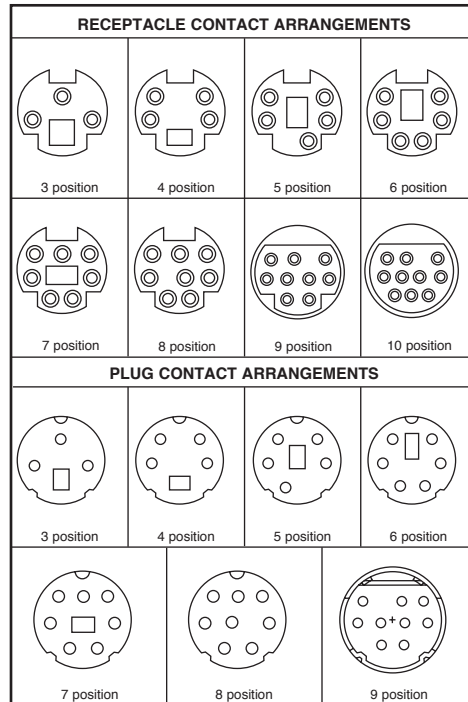

Circular Connectors Kycon